

## **DISASTER MANAGEMENT PLAN OF GOVERNMENT AIZAWL NORTH COLLEGE.**

The Disaster Management Plan of Government Aizawl North College is aimed to **ensure safety of the community and important assets of the institute.**

After proper analysis of probable risks for the institute, only two types of hazards are identified as likely to happen to the institute i.e. Earthquake and Fire. Therefore, this plan is prepared mainly against Earthquake and Fire, and is focusing on safety of the academic community and the assets of the institute and mitigation of impact led by earthquake and fire-breakout.

### **Objectives of the plan:**

- To prepare the community for any emergency response.
- To establish effective emergency response system.
- To define roles and responsibilities for effective response.
- To implement mitigation activities in the institute.

### **Location of the institute:**

The Government Aizawl North College is located in the heart of the Aizawl City, occupying 23° 44' 55" N 92° 43' 26" E 10 and covering 869.72 sq.m. It is 32 kms. from the Lengpui Airport.

The institute is having two buildings i.e. Main building and the annex building, and is sandwiched by the Nazareth hospital in the south and Mizofed Building in the north, while accessible main road in the east and district road in the west.

### **Demographic Details:**

| <b>A</b> | <b>Staff Position</b> |    |
|----------|-----------------------|----|
| 1        | Teaching              | 37 |
| 2        | Non-Teaching          | 12 |
| 3        | Female                | 18 |
| 4        | Male                  | 33 |

| <b>Students details</b> |        |  |
|-------------------------|--------|--|
| 1                       | Female |  |
| 2                       | Male   |  |

|   |                   |      |
|---|-------------------|------|
| 3 | Differently abled | Nil  |
|   | Total -           | 1647 |

| <b>Institute Building Profile:</b> |                                                 |                |
|------------------------------------|-------------------------------------------------|----------------|
| 1                                  | Horizontal Span                                 | 23.165 metres. |
| 2                                  | Vertical Extension                              | 21.336 meters. |
| 3                                  | Number of floors                                | 7              |
| 4                                  | No. of Doors for entry and exits for each floor | 6              |

| <b>Vulnerability of the Institute</b> |               |                    |                 |
|---------------------------------------|---------------|--------------------|-----------------|
| <i>S.No.</i>                          | <i>Hazard</i> | <i>Probability</i> | <i>Severity</i> |
| 1                                     | Earthquake    | High               | Very high       |
| 2                                     | Fire          | Medium             | High            |
| 3                                     | Landslide     | Very low           | Very low        |
| 4                                     | Lightning     | Medium             | Medium          |
| 5                                     | Floods        | Nil                | Nil             |
| 6                                     | Stampede      | Low                | Low             |

## **Preparedness**

### **1. Institutional Mechanism.**

- **Ex-officios-**

1. Principal – Prof.S.Haukhanlian Mate.
2. Vice Principal – Mr.K.Vanlalthaa.

- **Disaster Management Committee**

Chairman: Dr.H.Laldinmawia, Asst. Professor, Dept. of Geography.

Secretary: Ms. P.C.Remlalhruaii, Asst. Professor, Dept. Economics.

Members: Dr.Malsawmkima, Associate Professor, Dept. of English.

Mr.Lalchhanhima Tlau, Ass.Professor, Dept. of Mizo.

Mr.F.Vanlalhriatlina, LDC.

- **Emergency Response Team:**

**Event Commander:** Dr.Malsawmkima, Asso. Professor, Dept. of English.

**Assistant Commander:** Dr. H.Laldinmawia, Asst. Professor, Dept. of Geography.

**Secretary:** Ms.Remlalhruaii, Asst.Professor, Dept. of Economics.

All NCC members.

All NSS members.  
All Lengteng Adventure Club members.

• **Information dissemination team:**

1. *Convener* - Dr.Lalhmanmawia Chhakchhuak, Asso.Professor.  
Dept. of Pol. Science.
2. Mr. Jerry Lalmuansanga, Asst. Professor, Dept. of Pol.Science.
3. Mr.Sangthuamluaia, Asst.Professor, Dept. of Economics.

**Mitigation:**

**1. Evacuation Plan:**

Exit 1: Main Entrance.

Target room/group: Canteen, Establishment or Office, Library, IQAC room.

Exit 2: Doot at Students' Union Office.

Target room/group: S.U. Office, Students' Common room.

Exit 3: Back door of 203 room (at the north side).

Target room/group: 203 room, Principal's, Office and Examination room.

Exit 4: 3<sup>rd</sup> Floor Northside entrance/exit.

Target group/room: IGNOU, 301, 302, 303, 304, 305, 306 & Lab.room.

Exit 5: 4<sup>th</sup> Floor Entrance/Exit near Faculty Common room.

Target group/room: 405, 406, Vice Principal room, Faculty common room.

Exit 6: Upper entrance at 6<sup>th</sup> floor.

Target group/room: New floors (6<sup>th</sup> and 7<sup>th</sup> floors).

Exit 7: Entrance/Exit of Annex building.

Target group/rooms: A1, A3 & Lengteng Club room.

**2. Designated Head count Centres:**

1. Exit 1 & 2 – Opposite of Nazareth Hospital
2. Exit 3 & 4, & Exit 7 – Opposite of LAD Building.
3. Exit 5 & 6 – Near BCM, Ramhlun North.

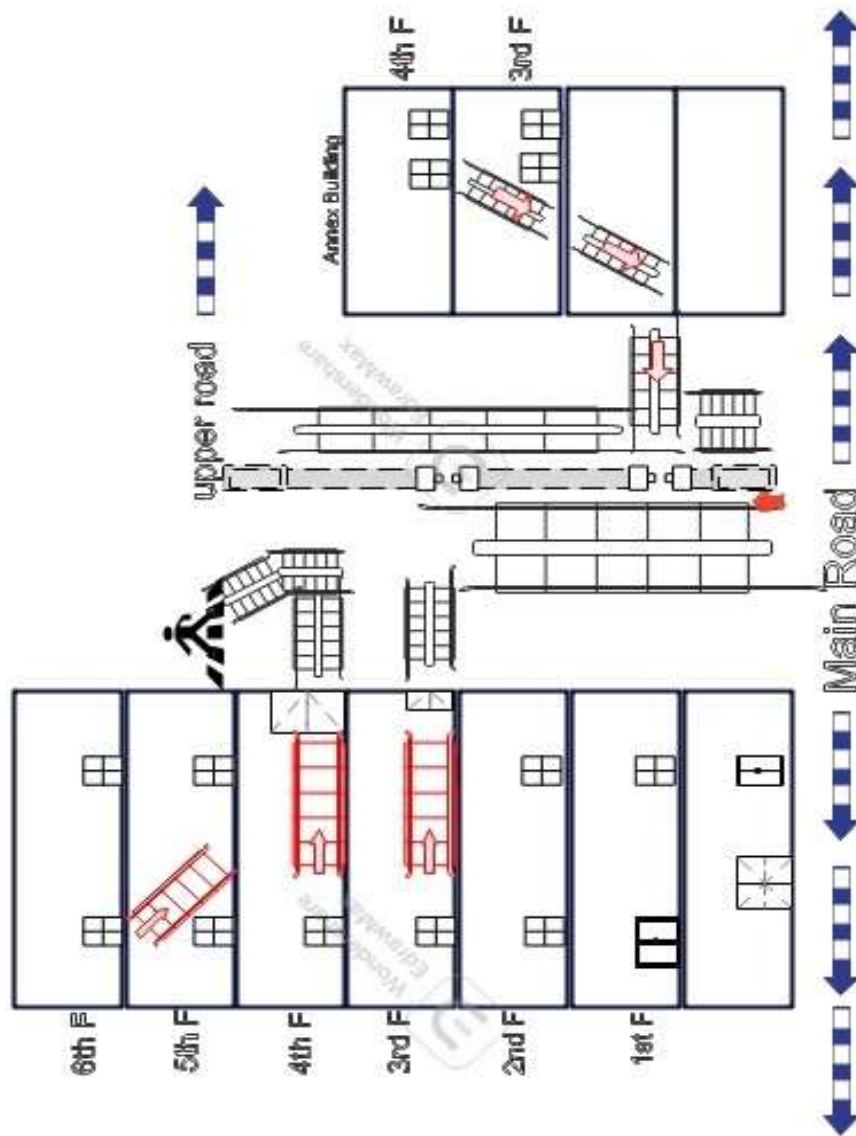

### 3. Plan of Safety measures:

- Floor incharges will be appointed at every semester.
- Class representatives are appointed as Room Incharges.

- MoU will be signed with Nazareth Hospital for health assistance.
- Mock drill or Fire and Earthquake within interval of six months will be organized.
- Placement of Fire extinguishers and Fire sand bucket at each floor.
- Use of fire-proof shelves in Offices and examination Office.
- Formation of Emergency Response Team including students and staffs.
- Training of ERT (emergency response team) will be organized.
- Sensitization of Staffs and students will be organized.

#### 4. **Resource Map:**

- Water taps in each toilet will be used for water points in times of fire break out.
- Water Hydrant of the PHE Department, GoM is located at the north east side of the building, near masonry.
- Rope, Light, First aids, etc. will be placed in Lengteng Adventure Club room. (?)
- Near Police Station i.e. Bawngkawn **Police station is 2 kms away from the institute.**
- Nazareth Hospital is the next building.

#### 5. **Proposal for improvement:**

- Retrofitting in the institute.

**Non-structural assessment** - Exterior elements such as parapets, windows, doors, interior elements such as suspended ceilings, lights, building utilities such as ACs, gas & water connection pipe and building contents such as table, chairs, file cabinets, computer, wall hangings etc. The assessment of these elements in order to identify and minimize the risk is known as Non-structural assessment. Assessment will be conducted by the Infrastructure and Learning Resource Committee with the assistance of the Disaster Management Committee of the institute.

#### **Structural Assessment -**

Structural elements of buildings are the structural members of the building of which the building is constructed. It includes foundation, columns, beams, floor system, roof system and connections between the structural members. The failure of any one member of the building may lead to collapse of the structure completely. The assessment of these structural members of a building is known as structural assessment. Assessment will be conducted by the Infrastructure and Learning Resource Committee with the assistance of the Disaster Management Committee of the institute.

**Important Contacts:**

1. Fire Service Organisation, Bawngkawn, Durtlang road – 9862370941 / 9436727944
2. Nazareth hospital – 0389 2391889
3. Bawngkawn Police station - 0389 2347570
4. Electricity complaint –
5. Water supply complaint –
6. District Authority – Pu L.Rinliana, AC Zonal Officer – 9436976513

**Calendar for Preparedness Activities.**

| Theme                                | Jan | Feb | Mar. | Apr. | May | June | July | Aug. | Sept. | Oct. | Nov. | Dec. |
|--------------------------------------|-----|-----|------|------|-----|------|------|------|-------|------|------|------|
| Sensitization of Students and staffs |     |     |      |      |     |      |      |      |       |      |      |      |
| ToT of ERT                           |     |     |      |      |     |      |      |      |       |      |      |      |
| Earthquake Mock drill                |     |     |      |      |     |      |      |      |       |      |      |      |
| Fire Mock drill                      |     |     |      |      |     |      |      |      |       |      |      |      |